

Assembly Instructions

KITCHEN ISLAND W/USB & POWER BOX

Caution: Please read instructions thoroughly before unpacking assembly parts. Sharp, exposed staple tips can cause injury, therefore, for your protection, please remove any exposed staples used in packing.

1. We recommend that you should assemble this product with the assistance of another person; this will make assembly easier, and will help to eliminate damage to the product or injury to persons during assembly.
2. Be sure to check all packing materials carefully for small parts that may have come loose inside the carton during shipment.
3. Please do not over tighten screws or bolts.
4. Please put all parts on a non-abrasive floor before assembly, and follow the assembly steps to assemble your newly purchased product correctly and efficiently.

PART LIST FOR KITCHEN ISLAND			
No.	PART DESC.	CODE.	Q'TY
A	Kitchen Island W/ Usb+Power Box - Table Top		1
B	Kitchen Island W/ Usb+Power Box - Wine Rack		1
C	Kitchen Island W/ Usb+Power Box - Front Left Leg	PDMN100KIPLEG1	1
D	Kitchen Island W/ Usb+Power Box - Back Left Leg	PDMN100KIPLEG2	1
E	Kitchen Island W/ Usb+Power Box - Front Right Leg	PDMN100KIPLEG3	1
F	Kitchen Island W/ Usb+Power Box - Back Right Leg	PDMN100KIPLEG4	1
G	Kitchen Island W/ Usb+Power Box - Side Short Stretcher	PDMN100KIPSTR1	1
H	Kitchen Island W/ Usb+Power Box - Center Long Stretcher	PDMN100KIPSTR2	1

HARDWARE LIST PACKED INSIDE BOX			
No.	HARDWARE DESC	CODE.	Q'TY
1	BOLT (5/16" x 60mm)	PDMN100KIPHW	8
2	SPRING WASHER (5/16")		8
3	FLAT WASHER (5/16)		8
4	BOLT (1/4" x 40mm)		6
5	BOLT (1/4" x 20mm)		1
6	SPRING WASHER (1/4")		7
7	FLAT WASHER (1/4)		7
8	ALLEN KEY (M4)		1
9	MENDING PLATE		1
10	METAL BRACKET		1
11	SCREW (#3.5 x 15mm)		4
12	SCREW (#4 x 45mm)		2

STEP:1

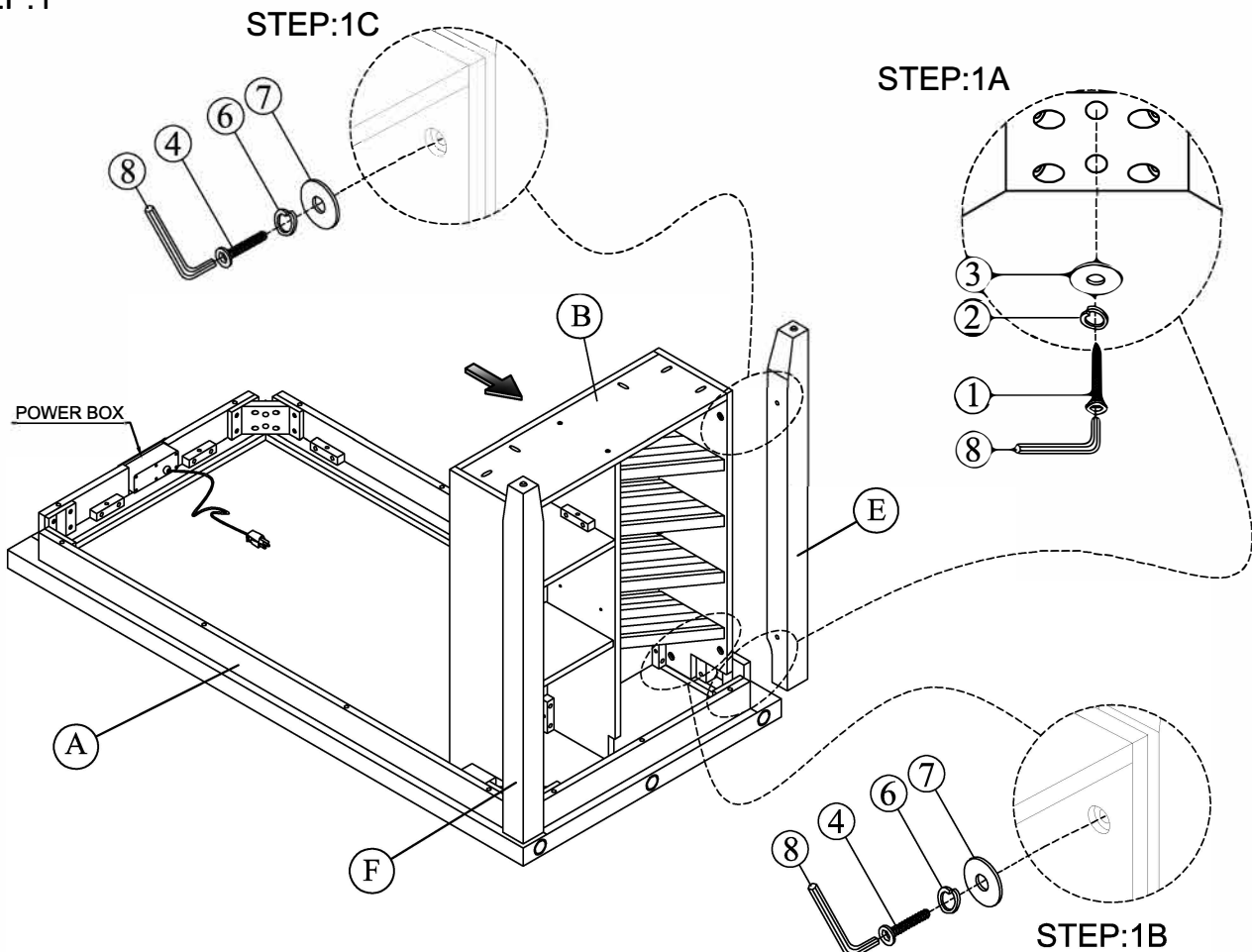

Assembly Instructions KITCHEN ISLAND W/USB & POWER BOX

STEP:2

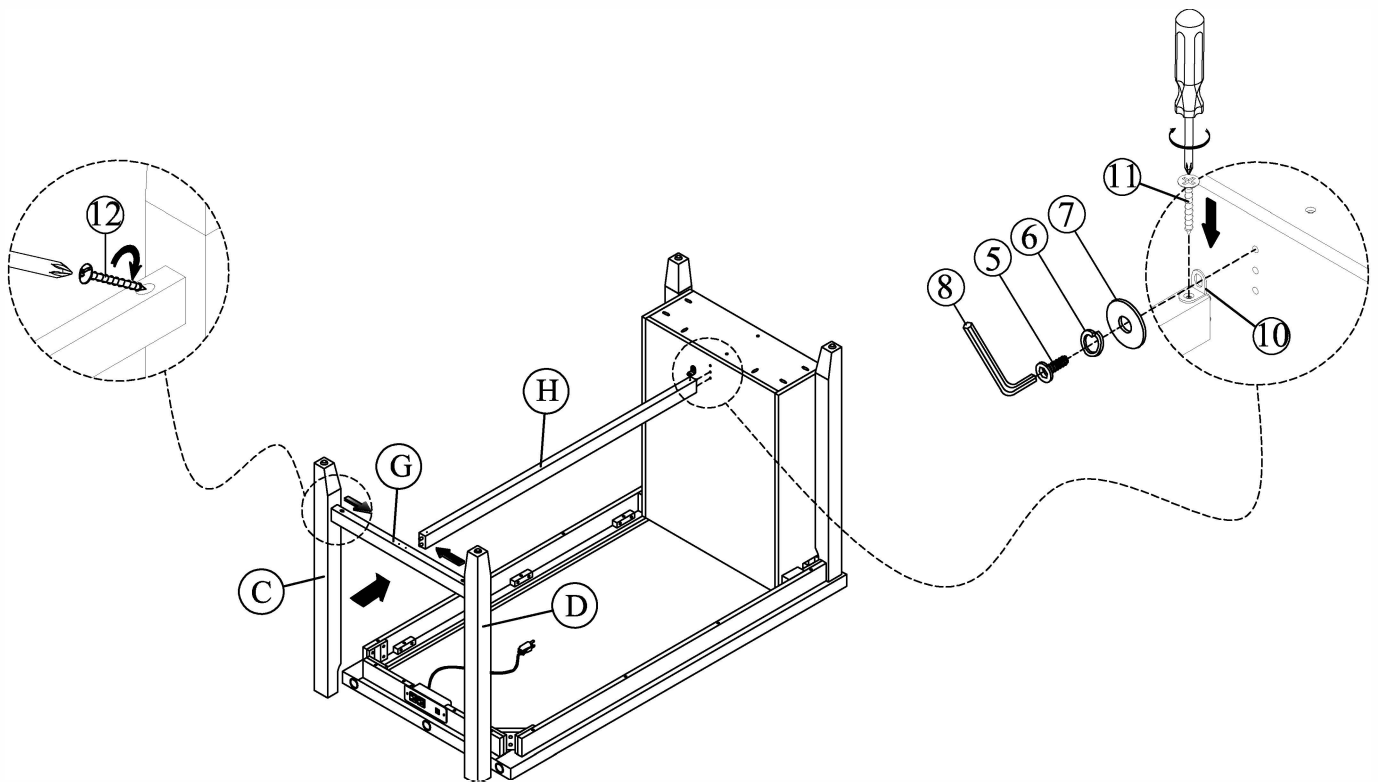

STEP:3

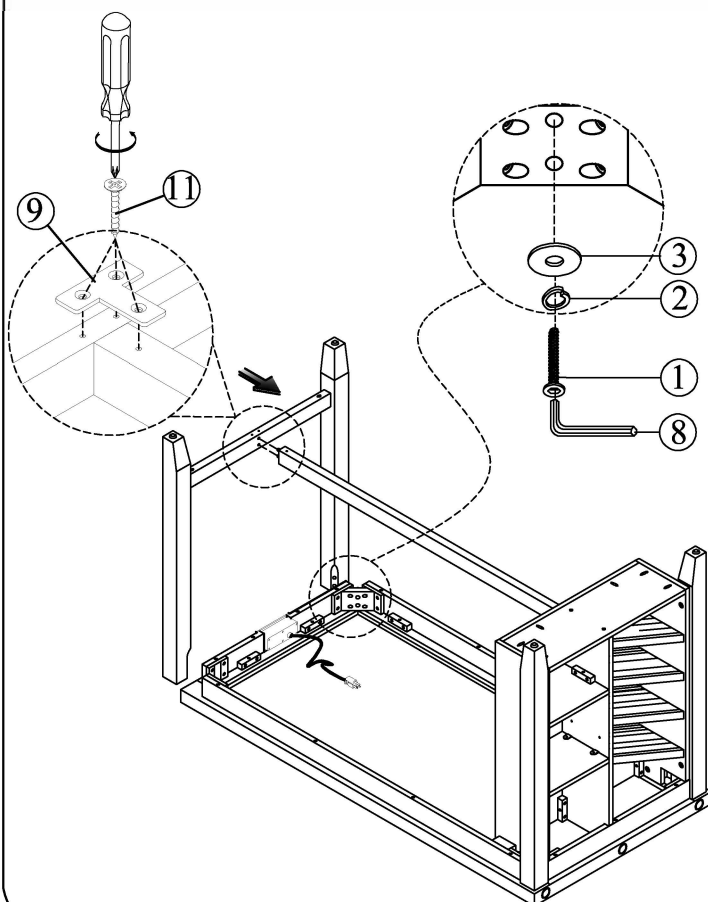

COMPLETED

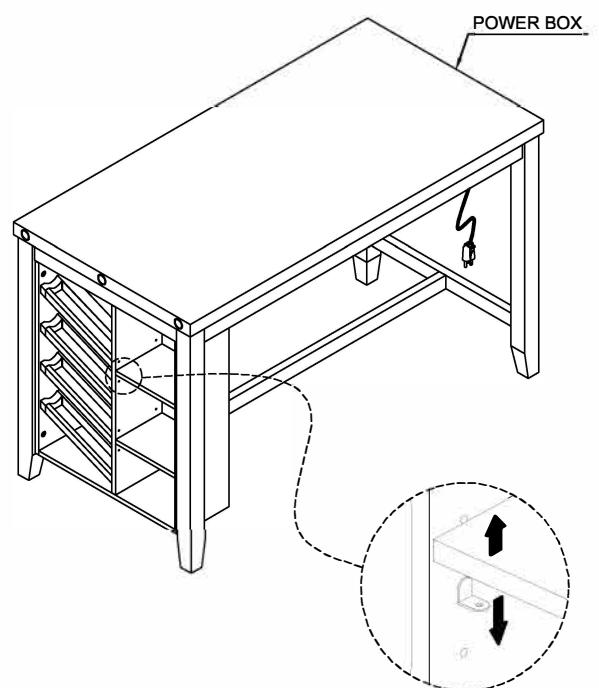



WARNING: To avoid serious personal injury:

- Carefully and strictly follow assembly instructions. Improper assembly of furniture can result in structural failure, instability of the product, or tip-over.
- Monitor and carefully control the assembly components. These include small parts and hardware that may present a choking hazard to small children. Bob's furniture should be assembled only by responsible adults and children should not be involved in the assembly process.
- Where provided, wall mounting hardware should always be used as prescribed in these instructions to anchor furniture to wall. Proper use of the wall mounting hardware can significantly reduce the potential for furniture tip-over and crushing injuries.