

## ASSEMBLY INSTRUCTIONS

6/6 Headboard & 6/6 Storage Footboard  
w/slats roll & 5/0-6/6 High Rails

THANK YOU FOR PURCHASING THIS QUALITY PRODUCT. BE SURE TO CHECK ALL PACKING MATERIAL CAREFULLY FOR SMALL PARTS THAT MAY HAVE COME LOOSE INSIDE THE CARTON DURING SHIPMENT.

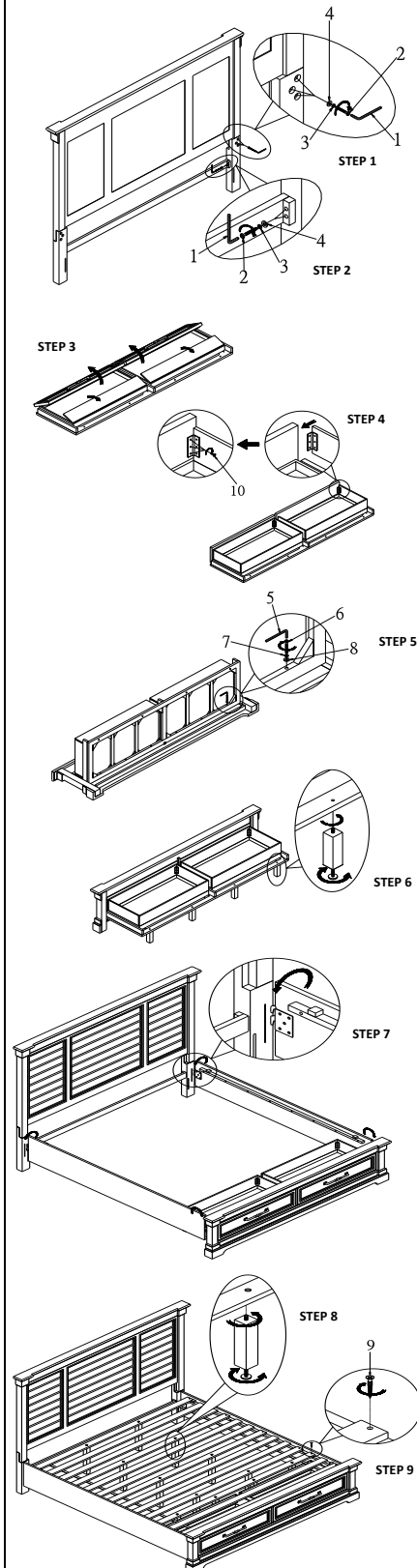

### TOOLS REQUIRED (NOT PROVIDED)

PHILLIPS SCREWDRIVER



### PARTS LIST:

NO	DESCRIPTION	SKETCH	QTY
A	HEADBOARD		1 PC
B	HEADBOARD POST (L + R)		2 PCS
C	CROSS BAR		1 PC
D	DRAWER BOX		1 PC
E	FOOTBOARD		1 PC
F	DRAWER SIDE PANEL		4 PCS
G	SIDE RAIL		2 PCS
H	DRAWER SUPPORT LEG		4 PCS
I	LONG SUPPORT LEG		8 PCS
J	SUPPORT LEG		4 PCS
K	BED SLATS ROLL		1 PC

### HARDWARE LIST:

HEADBOARD HARDWARE				
NO	DESCRIPTION	SKETCH	SIZE	QTY
1	ALEEN KEY		4 x 74 x 29mm	1 pc
2	BOLT		1/4" x 15 x 45mm	10 pcs
3	SPRING WASHER		1/4" x 11 x 2mm T	10 pcs
4	FLAT WASHER		1/4" x 18 x 2mm T	10 pcs
FOOTBOARD HARDWARE				
5	ALEEN KEY		4 x 74 x 29mm	1 pc
6	BOLT		1/4" x 15 x 70mm	6 pcs
7	SPRING WASHER		1/4" x 11 x 2mm T	6 pcs
8	FLAT WASHER		1/4" x 18 x 2mm T	6 pcs
9	SCREW		#8 x 30mm	12 pcs
10	SCREW		#6 x 10mm	24 pcs

- STEP 1: Attach headboard post (B) to headboard (A) by using allen key (1), bolt (2), spring washer (3), flat washer (4).  
STEP 2: Attach cross bar (C) to headboard post (B) by using allen key (1), bolt (2), spring washer (3), flat washer (4).  
STEP 3: Open drawer box (D).  
STEP 4: Attach drawer side panel (F) to drawer box (D) by using screw (10).  
STEP 5: Attach drawer box (D) to footboard (E) by using allen key (5), bolt (6), spring washer (7), flat washer (8).  
STEP 6: Attach drawer support leg (H) into drawer box (D) by turning clockwise.  
STEP 7: Attach side rail (G) to headboard and footboard.  
STEP 8: Attach support leg (J) and long support leg (I) to slats roll (K) by turning clockwise.  
STEP 9: Attach slats roll (K) on side rail by using screw (9).

Important note:

- Hardware bag for headboard is packed with Headboard.
- Hardware bag for footboard and slats is packed with Footboard.