

Ophelia Kitchen Cart

SKU# 2153002001

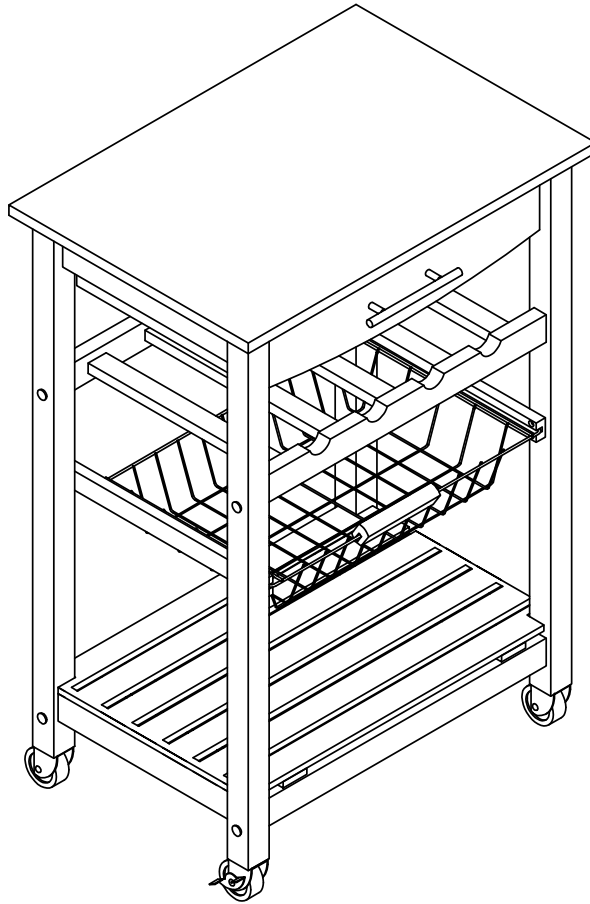

VDT-20581-VN

 **WARNING: To avoid serious personal injury:**

- Carefully and strictly follow assembly instructions. Improper assembly of furniture can result in structural failure, instability of the product, or tip-over.
- Monitor and carefully control the assembly components. These include small parts and hardware that may present a choking hazard to small children. Bob's furniture should be assembled only by responsible adults and children should not be involved in the assembly process.
- Where provided, wall mounting hardware should always be used as prescribed in these instructions to anchor furniture to wall. Proper use of the wall mounting hardware can significantly reduce the potential for furniture tip-over and crushing injuries.

MADE IN VIETNAM

PART LIST

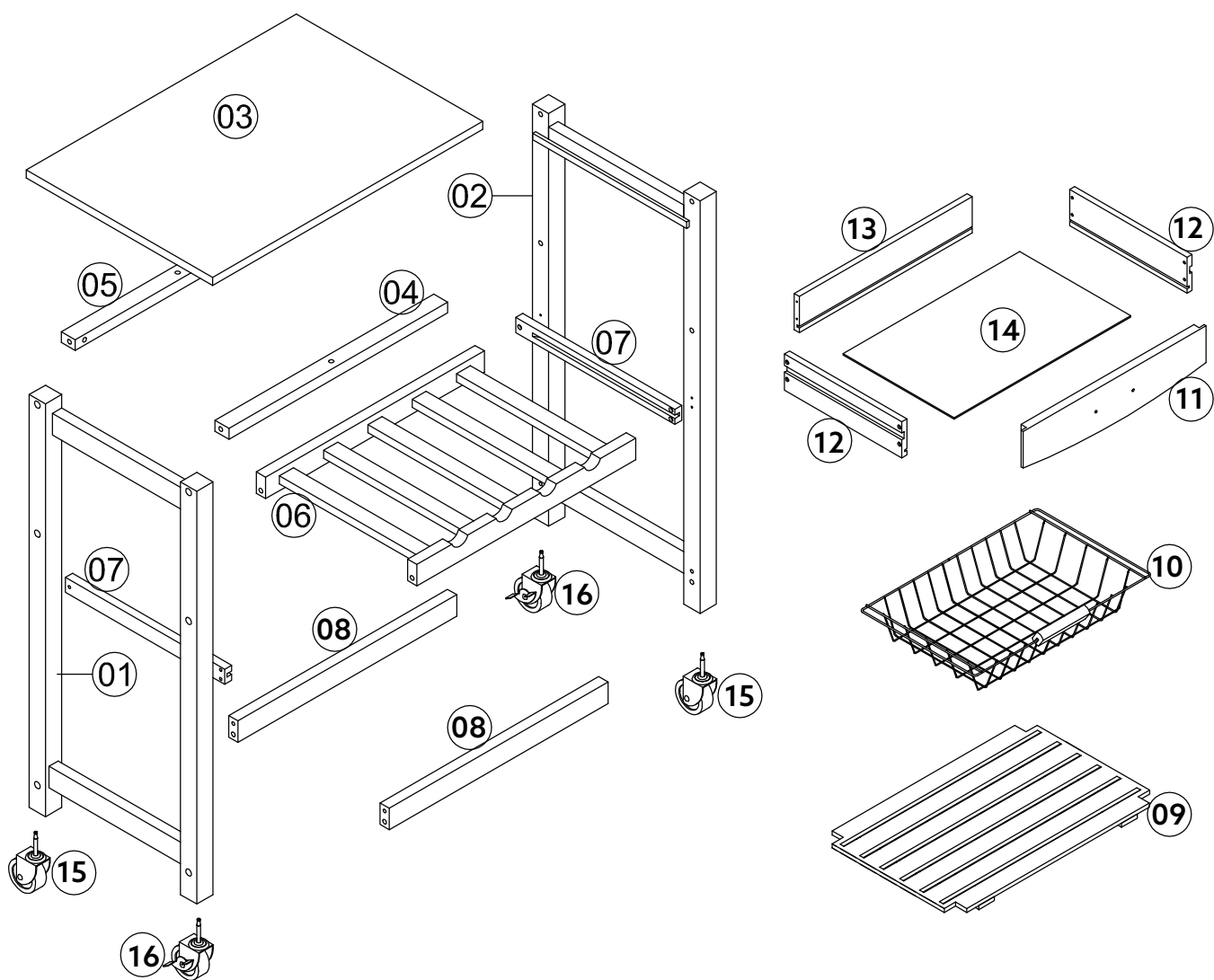

#1	LEFT FRAME	01
#2	RIGHT FRAME	01
#3	TOP PANEL	01
#4	UPPER RAIL-FRONT	01
#5	UPPER RAIL-BACK	01
#6	WINE RACK	01
#7	BASKET SLIDE RAIL	02

HARDWARE LIST

A		WOOD DOWEL (8X20MM)	02
B		WOOD DOWEL (6X30MM)	04
C		BOLT (1/4" x 50MM)	12
D		NUT	12
E		SCREW (1/8" x 25mm)	14
F		SCREW (1/8" x 15mm)	01
G		HANDLE	01
H		BOLT (M4 x 20mm)	02
I		WOODEN PLUG	12
J		DRAWERS STOP	01

NOTE: Find the label of "Hardware Enclosed" on one of the carton corner then follow the red ribbon to get the hardware bag.

TOOLS REQUIRED

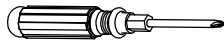
ALLEN KEY		SUPPLIED
PHILIPS SCREWDRIVER		NOT SUPPLIED

IMPORTANT:

1. Do not tighten bolts completely until all bolts are completely lined up and inserted into holes / nuts.
2. Do not over tighten screws and bolts to avoid stripping.
3. Please use hand tools to assemble this product. Do not use power tools.
4. For ease of assembly, two adults are recommended.

1.

Diagram 1 shows a hand using a screwdriver to attach a bracket (J) to a long wooden beam (04) using a screw (F).

J		01
F		01

2.

Diagram 2 shows the assembly of a wooden frame. The main diagram illustrates the frame structure with parts 01, 04, 05, 06, and 08. A circular inset provides a detailed view of the corner joint where parts 01 and 08 are connected. A hand is shown inserting a dowel (B) and a screw (C) through a hole in part 01 into part 08. A callout (D) points to a hole in part 08.

B		02
C		06
D		06

3.

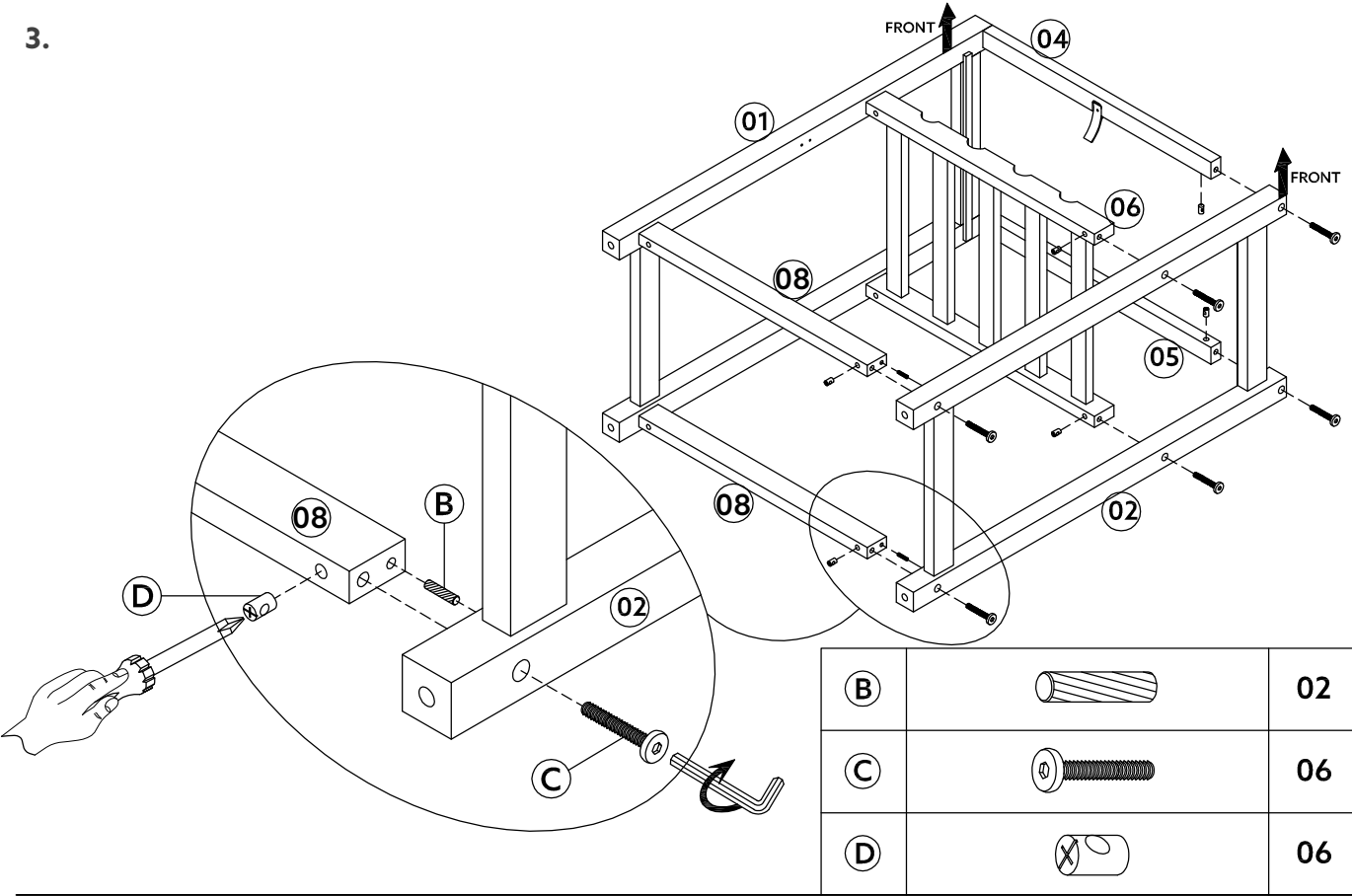

4.

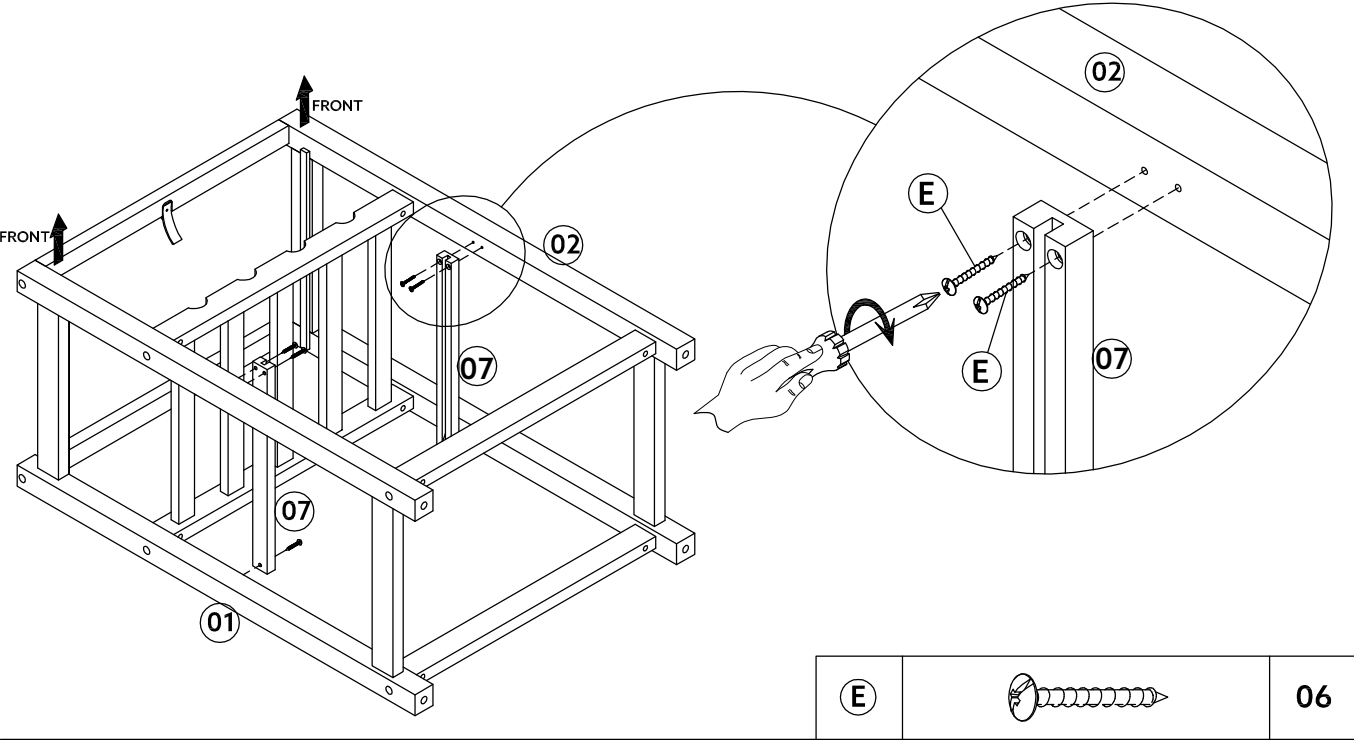

5.

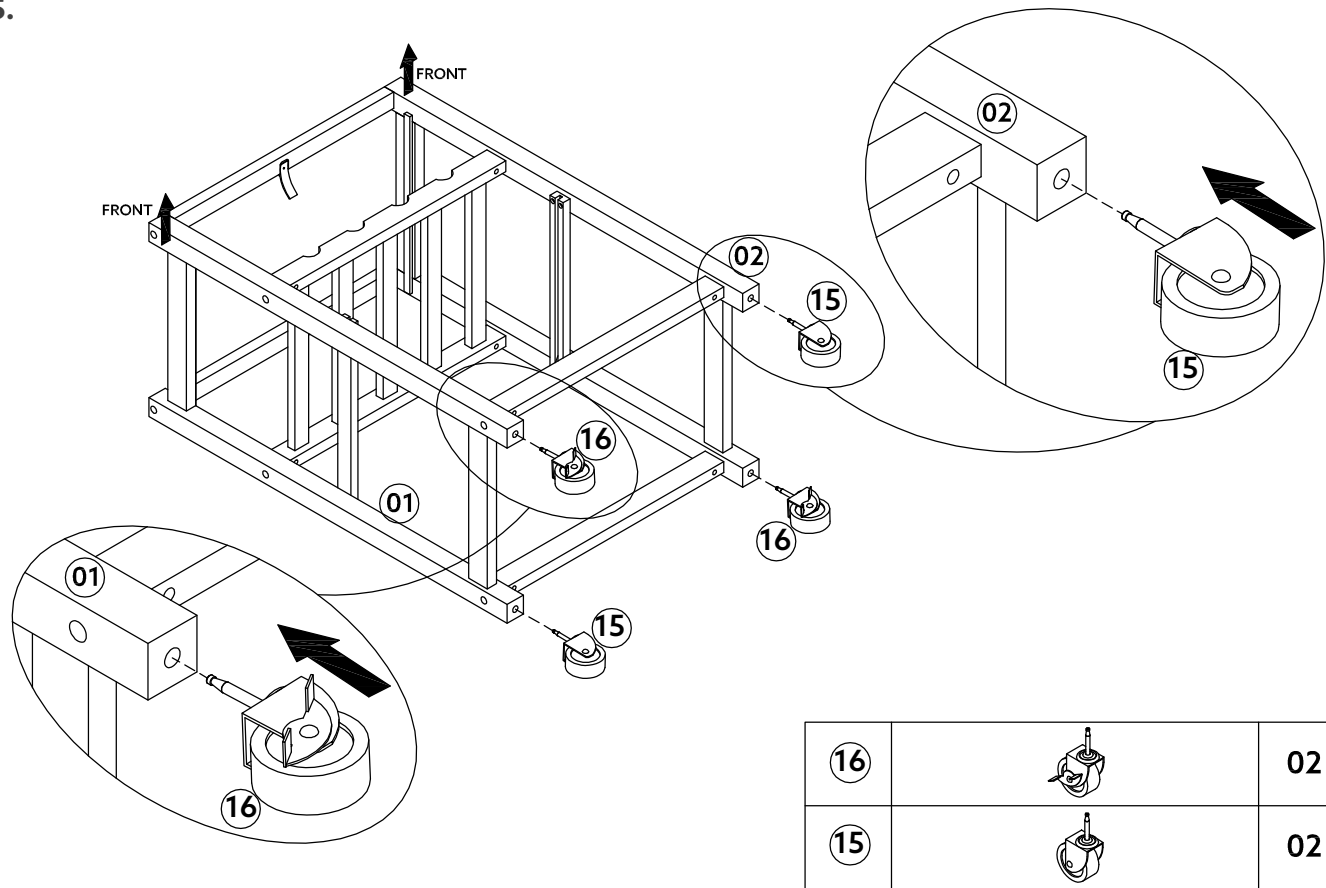

6.

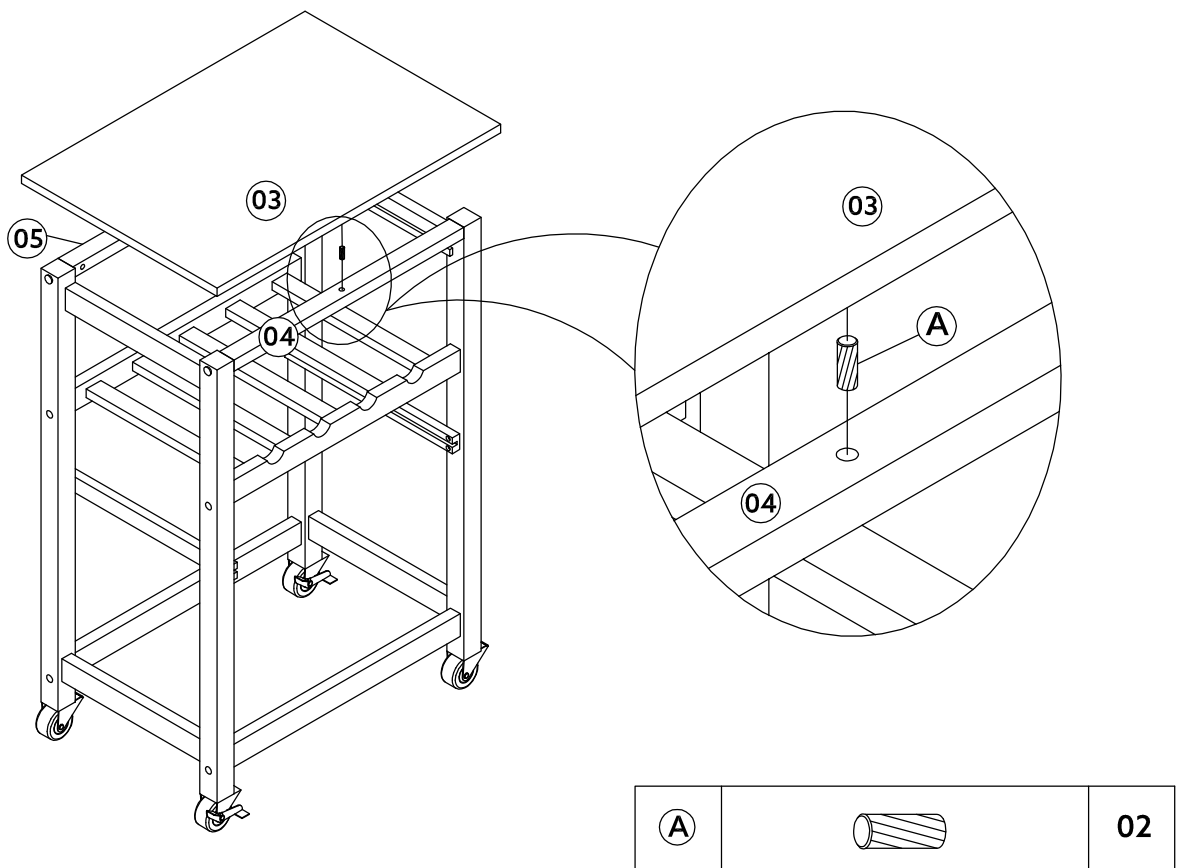

7.

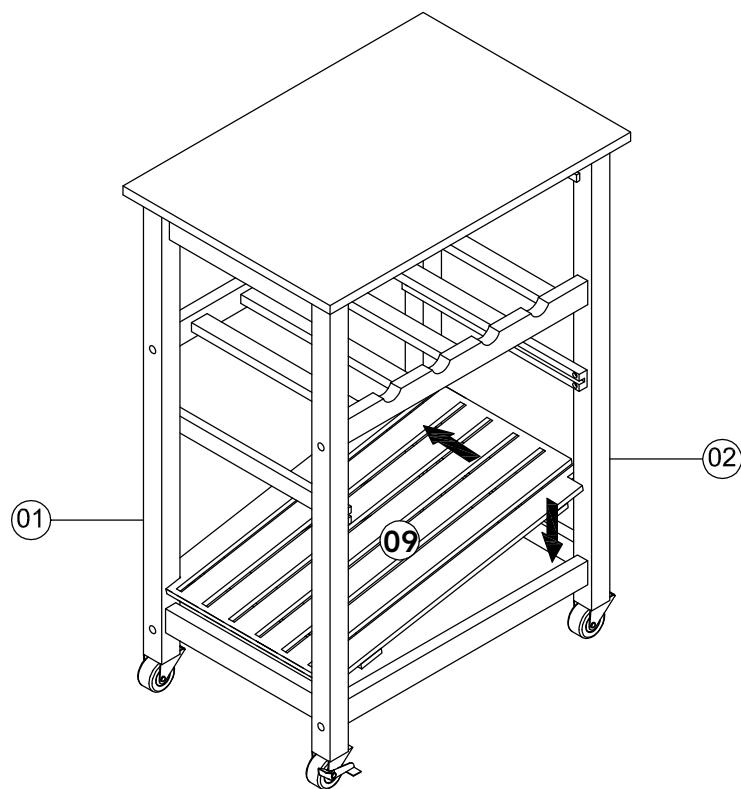

8.

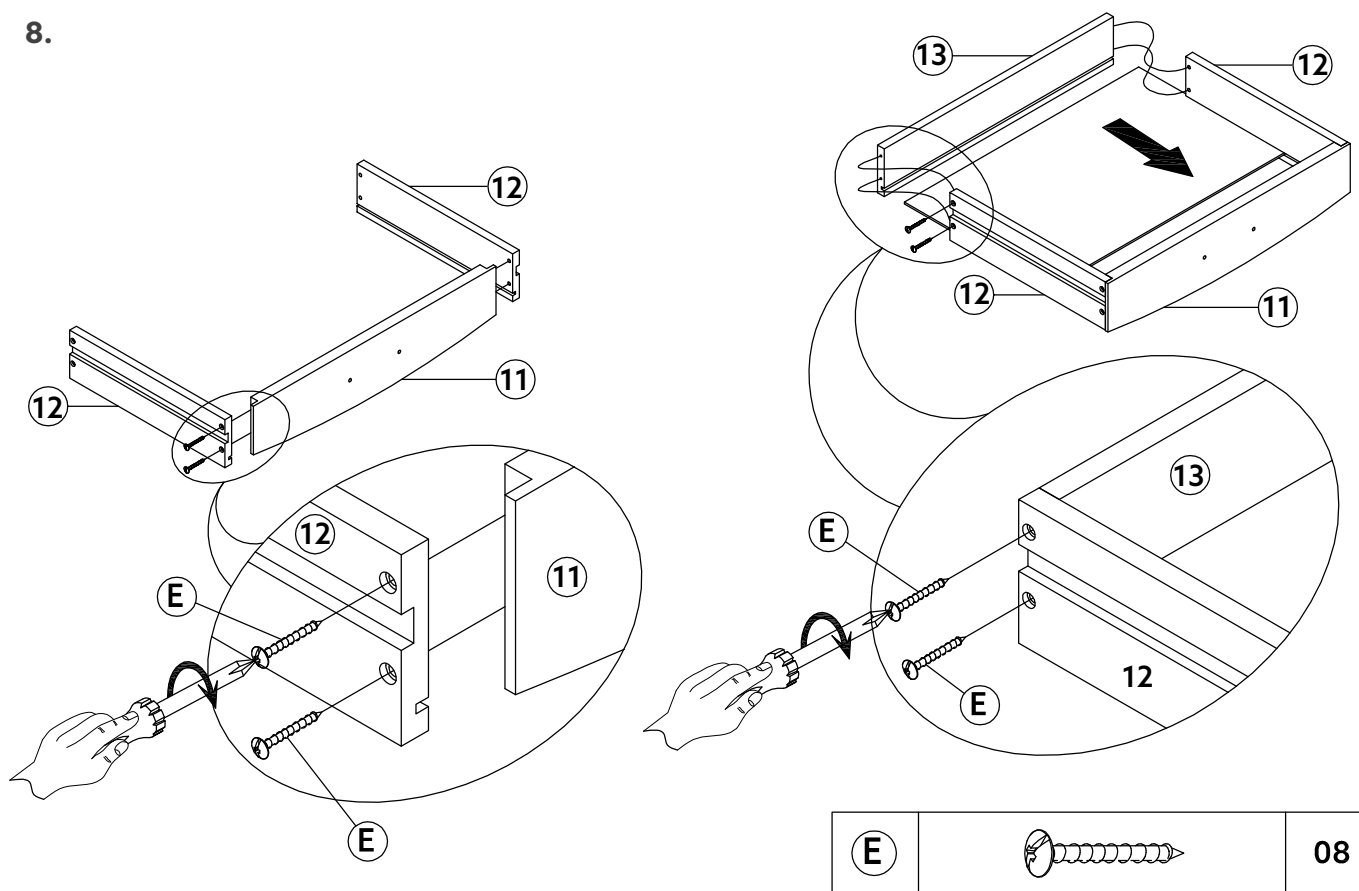

9.

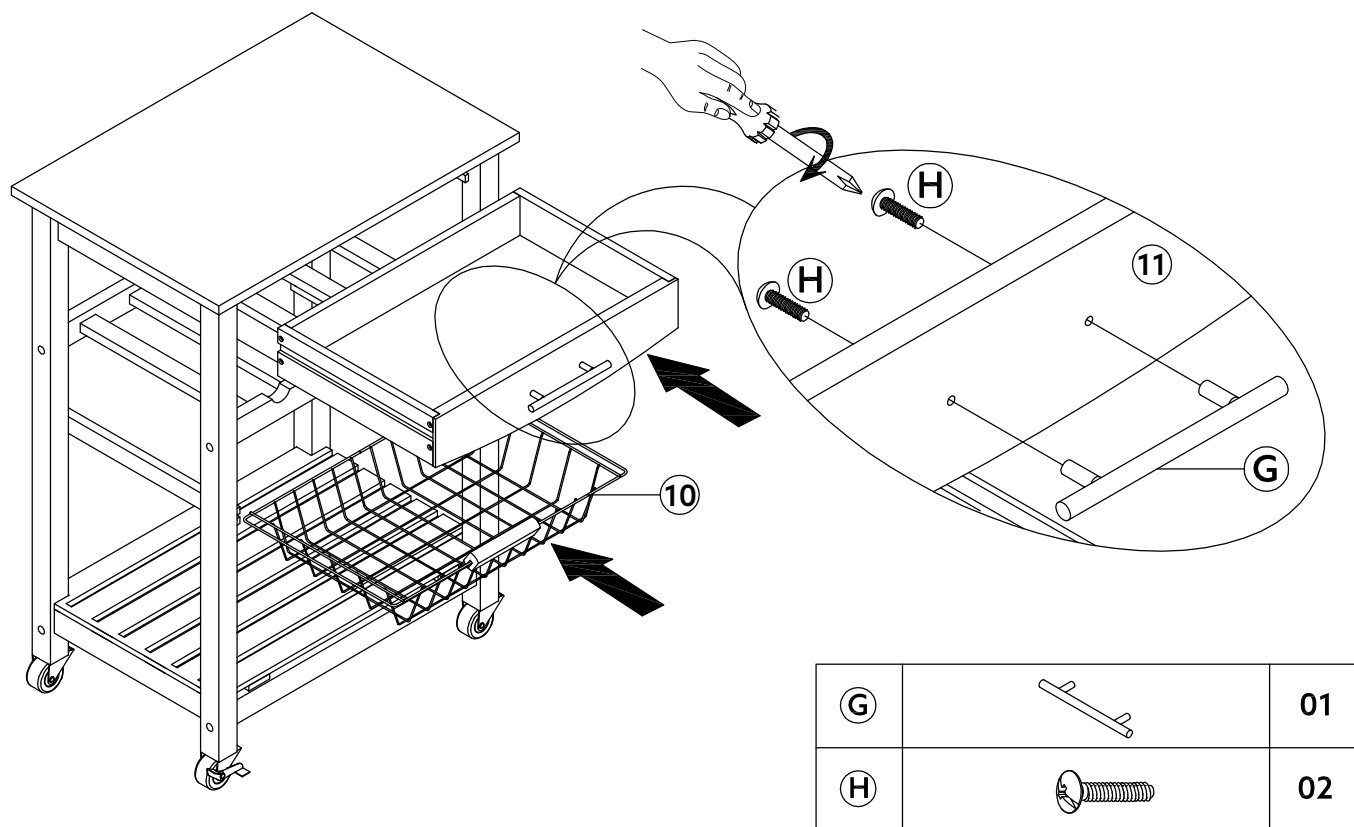

10.

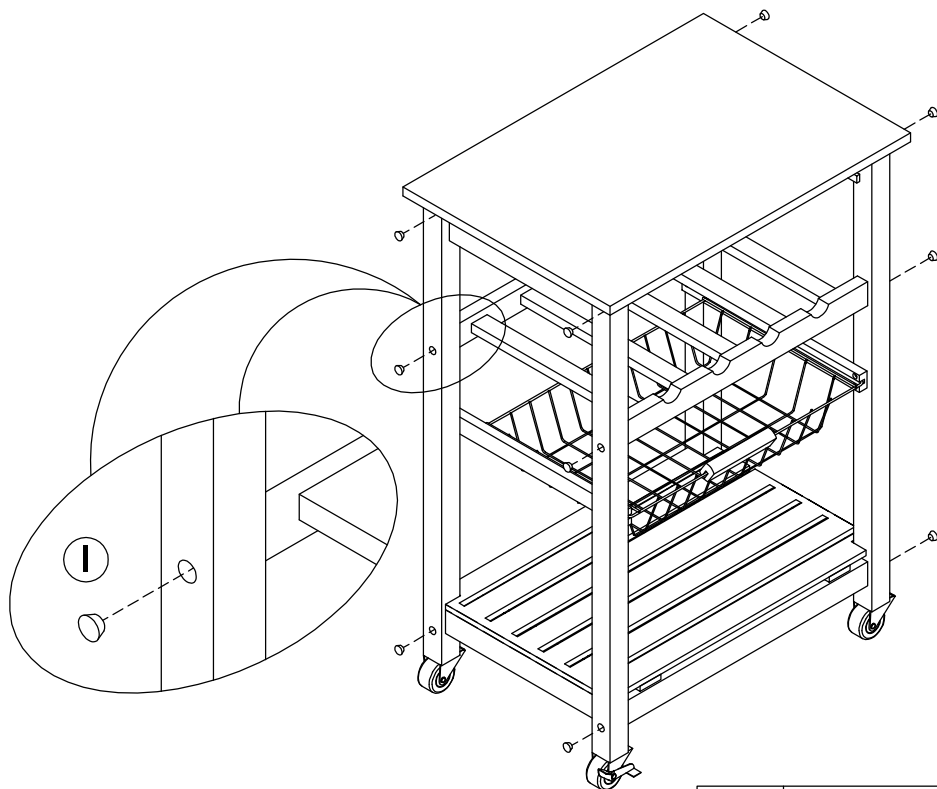

Tighten Bolt Firmly