

ASSEMBLY INSTRUCTION

BOB'S DISCOUNT **FURNITURE**

ASSEMBLY COMPLETED

PRODUCT NAME : BLAKE STORAGE DINING BENCH

HARDWARE LIST/LISTE DE QUINCAILLERIE

1	Bolt Ø5/16" x 65mm		8 PCS
	Boulon Ø5/16" x 65mm		
2	Spring washer Ø5/16" x 12mm		8 PCS
	Rondelle d'arret Ø5/16" x 12mm		
3	Flat washer Ø5/16" x 19mm		8 PCS
	Rondelle plate Ø5/16" x 19mm		
4	Wrench #12mm		1 PC
	CLÉ #12mm		

PARTS LIST / LISTE DE PIÈCES

			QTY'/QTÉ
A	Seat		1 PC
	Siege		
B	Leg		4 PCS
	Pieds		

STEP 1

ÉTAPE 1

Tightly fasten all bolts at this time

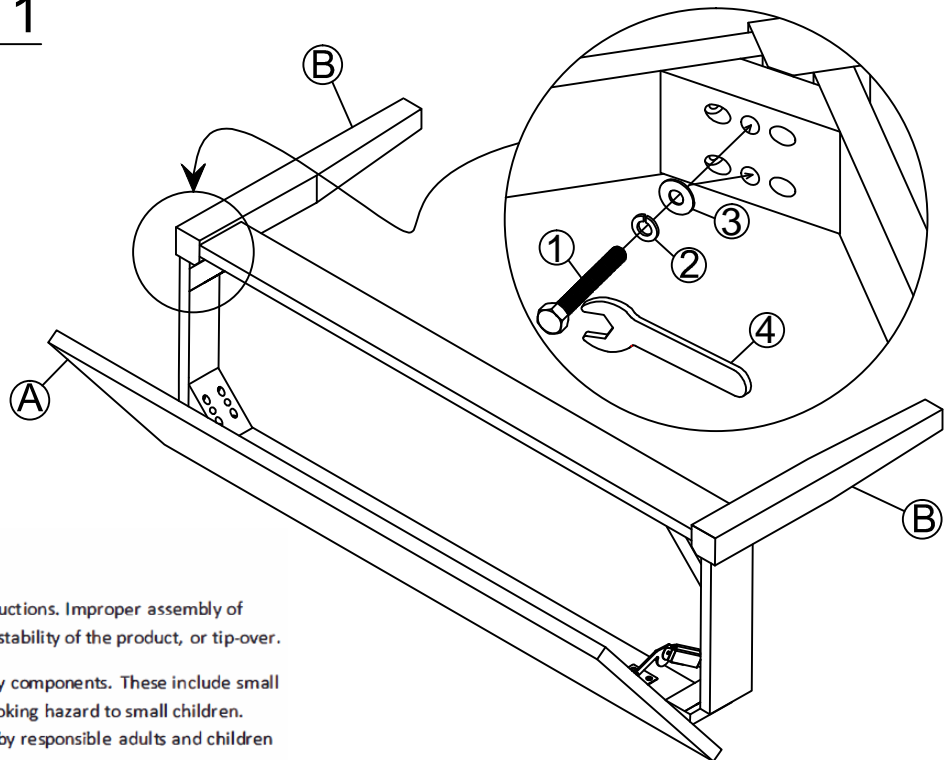

WARNING: To avoid serious personal injury:

- Carefully and strictly follow assembly instructions. Improper assembly of furniture can result in structural failure, instability of the product, or tip-over.
- Monitor and carefully control the assembly components. These include small parts and hardware that may present a choking hazard to small children. Bob's furniture should be assembled only by responsible adults and children should not be involved in the assembly process.
- Where provided, wall mounting hardware should always be used as prescribed in these instructions to anchor furniture to wall. Proper use of the wall mounting hardware can significantly reduce the potential for furniture tip-over and crushing injuries.

STEP 2

ÉTAPE 2

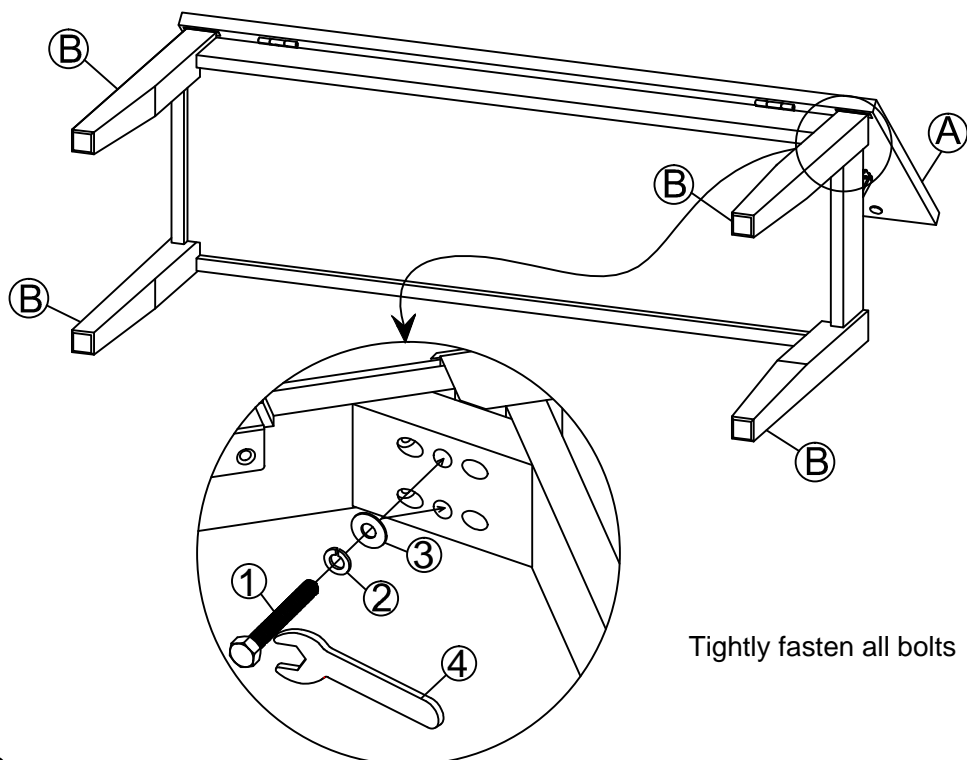

STEP 3

ÉTAPE 3

